

MECHANICAL TEES

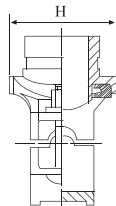
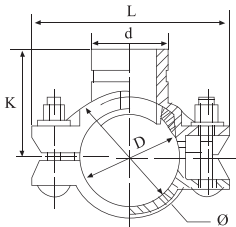

**XGQT3
Mechanical Tee Grooved**

Nominal Size		Pipe O.D.	Bolt Size	Max. Working Pressure		Dimensions				Hole Cut Dia	
Inch	mm	mm	mm	KPa	psi	K	Φ	L	H	Inch	mm
2x1	50x25	60.3x33.7	2-M10x65	2065	300	73	86	126	73	1 1/2"	38
2x1 1/4	50x32	60.3x42.4	2-M10x65	2065	300	73	86	126	73	1 3/4"	44
2x1 1/2	50x40	60.3x48.3	2-M10x65	2065	300	73	86	126	73	1 3/4"	44
2 1/2x1 1/4	65x32	73x42.4	2-M12x75	2065	300	77.5	101	132	80	1 3/4"	44
2 1/2x1 1/2	65x40	73x48.3	2-M12x75	2065	300	77.5	101	132	83	1 7/8"	48
2 1/2x1 1/4	65x32	76x42.4	2-M12x75	2065	300	79	104	138	80	1 3/4"	44
2 1/2x1 1/2	65x40	76x48.3	2-M12x75	2065	300	79	104	138	83	1 7/8"	48
3x1 1/4	80x32	88.9x42.4	2-M12x75	2065	300	86.5	118	150	80	1 3/4"	44
3x1 1/2	80x40	88.9x48.3	2-M12x75	2065	300	86.5	118	150	93	2 1/8"	54
3x2	80x50	88.9x60.3	2-M12x75	2065	300	85.5	113	150	94	2 1/2"	64
4x1 1/4	100x32	108x42.4	2-M12x75	2065	300	98	137	174	80	1 3/4"	44
4x1 1/2	100x40	108x48.3	2-M12x75	2065	300	98	137	174	93	2 1/8"	54
4x2	100x50	108x60.3	2-M12x75	2065	300	98	137	174	107	2 3/4"	70
4x2 1/2	100x65	108x76.1	2-M12x75	2065	300	102	137	174	117	3 1/8"	79
4x1 1/4	100x32	114.3x42.4	2-M12x75	2065	300	101	144	180	80	1 3/4"	44
4x1 1/2	100x40	114.3x48.3	2-M12x75	2065	300	101	144	180	93	2 1/8"	54
4x2	100x50	114.3x60.3	2-M12x75	2065	300	101	144	180/184	107	2 3/4"	70
4x2 1/2	100x65	114.3x73	2-M12x75	2065	300	105	144	180/184	117	3 1/8"	79
4x2 1/2	100x65	114.3x76.1	2-M12x75	2065	300	105	144	180/184	117	3 1/8"	79
4x3	100x80	114.3x88.9	2-M12x75	2065	300	102.5	139	184	119	3 1/2"	89
5x1 1/4	125x32	133x42.4	2-M12x95	2065	300	111.5	162	196	80	1 3/4"	44
5x1 1/2	125x40	133x48.3	2-M12x95	2065	300	111.5	164	196	93	2 1/8"	54
5x2	125x50	133x60.3	2-M16x100	2065	300	111.5	165	213	107	2 3/4"	70
5x2 1/2	125x65	133x76.1	2-M16x100	2065	300	111.5	165	213	117	3 1/8"	79
5x3	125x80	133x88.9	2-M16x100	2065	300	111.5	165	213	129	3 1/2"	89
5x1 1/4	125x32	139.7(141.3)x42.4	2-M12x95	2065	300	115	170	203	80	1 3/4"	44
5x1 1/2	125x40	139.7(141.3)x48.3	2-M12x95	2065	300	115	172	203	93	2 1/8"	54
5x2	125x50	139.7(141.3)x60.3	2-M16x100	2065	300	115	172	220	107	2 3/4"	70
5x2 1/2	125x65	139.7(141.3)x73	2-M16x100	2065	300	119	172	220	117	3 1/8"	79
5x2 1/2	125x65	139.7(141.3)x76.1	2-M16x100	2065	300	119	172	220	117	3 1/8"	79
5x3	125x80	139.7(141.3)x88.9	2-M16x100	2065	300	119	172	220	129	3 1/2"	89

All data contained here is subject to change without notice.
Note: Max. working pressure refers to FM registration pressure.

MECHANICAL TEES



XGQT3 Mechanical Tee Grooved

Nominal Size		Pipe O.D.	Bolt Size	Max. Working Pressure		Dimensions				Hole Cut Dia	
Inch	mm	mm	mm	KPa	psi	K	Φ	L	H	Inch	mm
6x1 1/4	150x32	159x42.4	2-M12x95	2065	300	125.5	188	223	80	1 3/4"	44
6x1 1/2	150x40	159x48.3	2-M12x95	2065	300	125.5	192	223	97	2 1/4"	57
6x2	150x50	159x60.3	2-M16x100	2065	300	125.5	193	242	107	2 3/4"	70
6x2 1/2	150x65	159x76.1	2-M16x100	2065	300	130	193	242	117	3 1/8"	79
6x3	150x80	159x88.9	2-M16x100	2065	300	130	193	242	129	3 1/2"	89
6x4	150x100	159x108	2-M16x100	2065	300	130	193	242	152	4 1/2"	114
6x4	150x100	159x114.3	2-M16x100	2065	300	130	193	242	152	4 1/2"	114
6x1 1/4	150x32	165.1x42.4	2-M12x95	2065	300	126.5	195	229	80	1 3/4"	44
6x1 1/2	150x40	165.1x48.3	2-M12x95	2065	300	128.5	199	229	96	2 1/4"	57
6x2	150x50	165.1x60.3	2-M16x100	2065	300	128.5	199	245	107	2 3/4"	70
6x2 1/2	150x65	165.1x73	2-M16x100	2065	300	133	199	245	117	3 1/8"	79
6x2 1/2	150x65	165.1x76.1	2-M16x100	2065	300	133	199	245	117	3 1/8"	79
6x3	150x80	165.1x88.9	2-M16x100	2065	300	133	199	245	129	3 1/2"	89
6x4	150x100	165.1x108	2-M16x100	2065	300	133	199	245	152	4 1/2"	114
6x4	150x100	165.1x114.3	2-M16x100	2065	300	133	199	245	152	4 1/2"	114
6x1 1/4	150x32	168.3x42.4	2-M12x95	2065	300	128	198	232	80	1 3/4"	44
6x1 1/2	150x40	168.3x48.3	2-M12x95	2065	300	130	201	232	96	2 1/4"	57
6x2	150x50	168.3x60.3	2-M16x100	2065	300	130	201	248	107	2 3/4"	70
6x2 1/2	150x65	168.3x73	2-M16x100	2065	300	134	201	248	117	3 1/8"	79
6x2 1/2	150x65	168.3x76.1	2-M16x100	2065	300	134	201	248	117	3 1/8"	79
6x3	150x80	168.3x88.9	2-M16x100	2065	300	134	201	248	129	3 1/2"	89
6x4	150x100	168.3x108	2-M16x100	2065	300	134	201	248	152	4 1/2"	114
6x4	150x100	168.3x114.3	2-M16x100	2065	300	134	201	248	152	4 1/2"	114
8x2	200x50	219.1x60.3	2-M16x110	2065	300	155.5	253	300	107	2 3/4"	70
8x2 1/2	200x65	219.1x73	2-M16x110	2065	300	160	253	300	117	3 1/8"	79
8x2 1/2	200x65	219.1x76.1	2-M16x110	2065	300	160	253	300	117	3 1/8"	79
8x3	200x80	219.1x88.9	2-M16x110	2065	300	160	253	300	129	3 1/2"	89
8x4	200x100	219.1x108	2-M16x110	2065	300	160	253	300	152	4 1/2"	114
8x4	200x100	219.1x114.3	2-M16x110	2065	300	160	253	300	152	4 1/2"	114
10x2	250x50	273x60.3	2-M20x110	1205	175	182.5	307	382	107	2 3/4"	70
10x2 1/2	250x65	273x73	2-M20x110	1205	175	186.5	307	382	117	3 1/8"	79
10x2 1/2	250x65	273x76.1	2-M20x110	1205	175	186.5	307	382	117	3 1/8"	79
10x3	250x80	273x88.9	2-M20x110	1205	175	186.5	307	382	129	3 1/2"	89
10x4	250x100	273x108	2-M20x110	1205	175	186.5	307	382	152	4 1/2"	114
10x4	250x100	273x114.3	2-M20x110	1205	175	186.5	307	382	152	4 1/2"	114

All data contained here is subject to change without notice.
Note: Max. working pressure refers to FM registration pressure.